



Land and Environment Court New South Wales

Medium Neutral Citation:	Sell & Parker Pty Ltd v Minister for Planning [2017] NSWLEC 1586
Hearing dates:	Conciliation conference on 19 September & 17 October 2017
Date of orders:	19 October 2017
Decision date:	19 October 2017
Jurisdiction:	Class 1
Before:	Maston AC
Decision:	See (4) below
Catchwords:	DEVELOPMENT APPLICATION: conciliation conference; agreement between the parties; orders
Legislation Cited:	Land and Environment Court Act 1979
Category:	Principal judgment
Parties:	Sell and Parker Pty Ltd (ACN 000 101 315) (Applicant) Minister for Planning (Respondent)
Representation:	Mr J Johnson, Allens(Applicant) Ms L Sims, Department of Planning (Respondent)
File Number(s):	2017/126126
Publication restriction:	No

JUDGMENT

- 1** **COMMISSIONER:** In this matter, at or after a conciliation conference, an agreement under s 34(3) of the *Land and Environment Court Act 1979* (the Court Act) was reached between the parties as to the terms of a decision in the proceedings that was acceptable to the parties. As the presiding Commissioner, I was satisfied that the decision was one that the Court could have made in the proper exercise of its functions (this being the test applied by s 34(3) of the Court Act). As a consequence, s 34(3)(a) of the Act required me to “dispose of the proceedings in accordance with the decision”.

2

The Court Act also required me to "set out in writing the terms of the decision" (s 34(3) (b)). The orders made to give effect to the agreement constitute that document.

3 In making the orders to give effect to the agreement between the parties, I was not required to make, and have not made, any merit assessment of the issues that were originally in dispute between the parties.

4 The final orders to give effect to the parties' agreement under s34(3) of the Land and Environment Court Act 1979 are:

(1) Leave is granted to the Applicant to rely on the following amended plans and documents:

Document	Revision Date	Prepared by: (consultant)
Drawing DA-1049-14 A101 Rev M	21/9/2017	Algorry Zappia and Associates Pty Ltd
Drawing DA-1049-14 A301 Rev H	27/9/2017	Algorry Zappia and Associates Pty Ltd
Drawing 14023-16-001-FH-01 Rev P4	25/9/2017	MJ Harvey and Associates Pty Ltd
Drawing SS15-3178-000-I	22/9/2017	Site Image (NSW) Pty Ltd
Drawing SS15-3178-101-J	22/9/2017	Site Image (NSW) Pty Ltd
Drawing SS15-3178-401-G	15/8/2017	Site Image (NSW) Pty Ltd
Drawing SS15-3178-402-I	22/9/2017	Site Image (NSW) Pty Ltd
Drawing SS15-3178-403-G	15/8/2017	Site Image (NSW) Pty Ltd
Drawing SS15-3178-404-G	22/9/2017	Site Image (NSW) Pty Ltd
Drawing SS15-3178-501-I	22/9/2017	Site Image (NSW) Pty Ltd
Town Planning Report	29/9/2017	Tim Ward (Ethos Urban)
Acoustic Report	25/9/2017	Renzo Tonin and Associates

(2) The Applicant is to pay the Respondent's costs thrown away by reason of the amended plans and documents listed above under section 97B of the *Environmental Planning and Assessment Act 1979* as agreed or assessed.

- (3) The appeal is upheld.
- (4) Modification application No. SSDMod 16_8001, is approved, subject to the conditions set out in Annexure "A".

.....

John Maston

Acting Commissioner of the Land & Environment Court of NSW

[Annexure A \(75.7 KB, pdf\)](#)

[Plans \(8.24 MB, pdf\)](#)

DISCLAIMER - Every effort has been made to comply with suppression orders or statutory provisions prohibiting publication that may apply to this judgment or decision. The onus remains on any person using material in the judgment or decision to ensure that the intended use of that material does not breach any such order or provision. Further enquiries may be directed to the Registry of the Court or Tribunal in which it was generated.

Decision last updated: 03 November 2017

ANNEXURE A

Sell and Parker Pty Limited v Minister for Planning

SCHEDULE 1

Application No:	SSD 5041
Applicant:	Sell and Parker Pty Ltd
Consent Authority:	Land and Environment Court of NSW
Development:	Increasing the processing capacity of the existing metal recycling facility, including reconfiguration and expansion of the facility into the adjoining site at 23-43 Tatersall Road, Kings Park.
Date of Original Consent:	12 November 2015
Modification:	SSD 5041 MOD 1- the modification includes amendments to the site layout, design of buildings and structures and alterations and additions to existing buildings and structures

SCHEDULE 2

This consent is modified as follows:

In Schedule 1

1. In the table of definitions, insert the following definitions in alphabetical order:

Expanded Operations	The point at which the site receives or processes in excess of 90,000 tonnes per calendar year of waste
FRNSW	Fire and Rescue New South Wales
NCC	National Construction Code
Waste	As defined in the POEO Act In Schedule 2
2. Delete and replace Condition A2 as follows:
 - A2. The Applicant shall carry out the Development in accordance with the:
 - (a) EIS prepared by ERM dated July 2014;
 - (b) Response to Submissions report prepared by ERM dated 7 January 2015;
 - (c) Supplementary Response to Submissions prepared by Mecone dated 30 June 2015;

- (d) Supplementary Response to Submissions prepared by Sell and Parker Pty Ltd dated 3 September 2015;
 - (e) Site layout plans and drawings (See Appendix A);
 - (f) Management and Mitigation Measures (see Appendix B);
 - (g) Modification Application SSD 5041 MOD 1 and accompanying document titled *Statement of Environmental Effects 23-43 and 45 Tattersall Road, Kings Park* dated August 2016 prepared by Higgins Planning, additional information from Higgins Planning dated 22 December 2016, further additional information from Allens and Linklaters dated 9 February 2017 and the Town Planning Report prepared by Ethos Consulting on 29 September 2017.
3. Insert Condition B35A as follows:
- B35A. Prior to:
- (i) expanded operations;
 - (ii) the issue of an Occupation Certificate; or
 - (iii) the date being 6 months after the determination of MOD 1 by the Land and Environment Court,
- (whichever is sooner), the Applicant must ensure that an appropriate sprinkler system and smoke detection system have been installed within the floc storage area in Building C to the satisfaction of FRNSW.
4. Insert Condition E35B as follows: B35B
- Prior to:
- (i) expanded operations;
 - (ii) the issue of an Occupation Certificate; or
 - (iii) the date being 7 months after the determination of MOD 1 by the Land and Environment Court,
- (whichever is sooner), the Applicant must ensure that all fire safety measures required by the NCC for Buildings A, B, & C (as shown on drawing 14023-16-001-FH-01 Rev P4) have been installed and verified through a Fire Safety Audit in accordance with Australian Standard 4655 – Fire Safety Audits, to the satisfaction of FRNSW.
5. Delete Condition B19(viii) and replace as follows:
- (viii) installation of appropriate dust screens at the property boundary and replacement of dust screens and shade cloths at the Tattersall Road boundary of the 45 Tattersall Road site.

6. Replace all drawings in Appendix A with the following:

PROPOSED ALTERATIONS TO EXISTING RECYCLING CENTRE 23-43 & 45 TATTERSALL RD, KINGS PARK LANDSCAPE

DRAWINGS	DWG NO.	DRAWING TITLE	SCALE
	000	COVERSHEET	N/A
	101	LANDSCAPE MASTERPLAN	1:500
	401	LANDSCAPE PLAN	1:250
	402	LANDSCAPE PLAN	1:250
	403	LANDSCAPE PLAN	1:250
	404	LANDSCAPE PLAN	1:250
	501	LANDSCAPE DETAILS	AS SHOWN

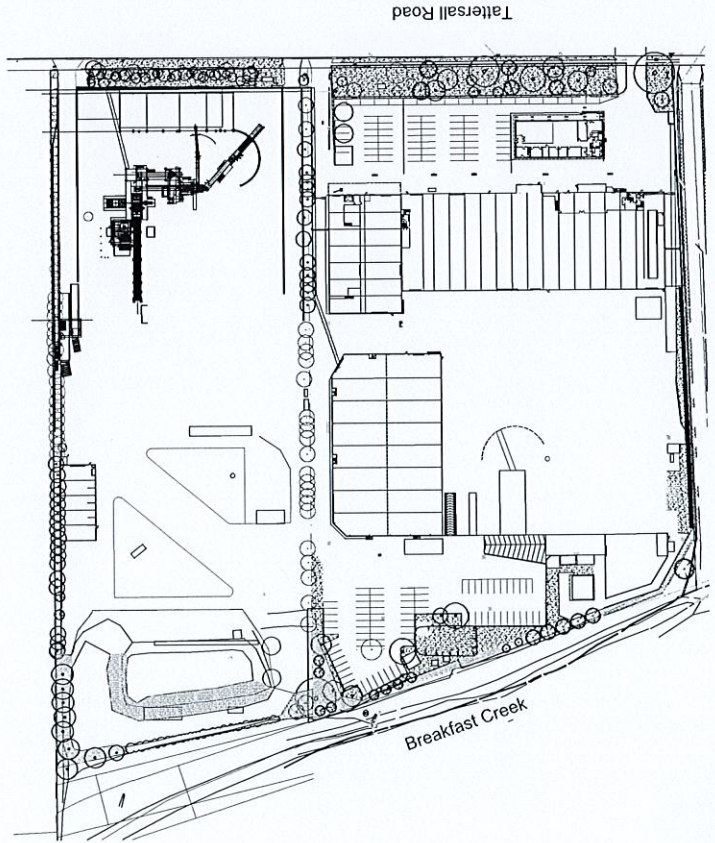

© 2016 Site Image Pty Ltd. All rights reserved. This drawing is the property of Site Image Pty Ltd and is not to be reproduced, stored in a retrieval system, or transmitted in any form or by any means, electronic, mechanical, photocopying, recording, or by any information storage and retrieval system, without the prior written permission of Site Image Pty Ltd. The contractor shall verify all work on site including work by others before commencing the landscape installation. Any alterations are to be made in consultation with the landscape architect. Do not make any changes. Any required consent must be obtained from the relevant authority before any work is undertaken. The contractor shall be held responsible for any damage to the site or surrounding property.

REV	DATE	DESCRIPTION
1	15.08.2017	Final Design
2	15.08.2017	Final Design
3	15.08.2017	Final Design
4	15.08.2017	Final Design
5	15.08.2017	Final Design
6	15.08.2017	Final Design
7	15.08.2017	Final Design
8	15.08.2017	Final Design
9	15.08.2017	Final Design
10	15.08.2017	Final Design
11	15.08.2017	Final Design
12	15.08.2017	Final Design
13	15.08.2017	Final Design
14	15.08.2017	Final Design
15	15.08.2017	Final Design
16	15.08.2017	Final Design
17	15.08.2017	Final Design
18	15.08.2017	Final Design
19	15.08.2017	Final Design
20	15.08.2017	Final Design
21	15.08.2017	Final Design
22	15.08.2017	Final Design
23	15.08.2017	Final Design
24	15.08.2017	Final Design
25	15.08.2017	Final Design
26	15.08.2017	Final Design
27	15.08.2017	Final Design
28	15.08.2017	Final Design
29	15.08.2017	Final Design
30	15.08.2017	Final Design
31	15.08.2017	Final Design
32	15.08.2017	Final Design
33	15.08.2017	Final Design
34	15.08.2017	Final Design
35	15.08.2017	Final Design
36	15.08.2017	Final Design
37	15.08.2017	Final Design
38	15.08.2017	Final Design
39	15.08.2017	Final Design
40	15.08.2017	Final Design
41	15.08.2017	Final Design
42	15.08.2017	Final Design
43	15.08.2017	Final Design
44	15.08.2017	Final Design
45	15.08.2017	Final Design
46	15.08.2017	Final Design
47	15.08.2017	Final Design
48	15.08.2017	Final Design
49	15.08.2017	Final Design
50	15.08.2017	Final Design
51	15.08.2017	Final Design
52	15.08.2017	Final Design
53	15.08.2017	Final Design
54	15.08.2017	Final Design
55	15.08.2017	Final Design
56	15.08.2017	Final Design
57	15.08.2017	Final Design
58	15.08.2017	Final Design
59	15.08.2017	Final Design
60	15.08.2017	Final Design
61	15.08.2017	Final Design
62	15.08.2017	Final Design
63	15.08.2017	Final Design
64	15.08.2017	Final Design
65	15.08.2017	Final Design
66	15.08.2017	Final Design
67	15.08.2017	Final Design
68	15.08.2017	Final Design
69	15.08.2017	Final Design
70	15.08.2017	Final Design
71	15.08.2017	Final Design
72	15.08.2017	Final Design
73	15.08.2017	Final Design
74	15.08.2017	Final Design
75	15.08.2017	Final Design
76	15.08.2017	Final Design
77	15.08.2017	Final Design
78	15.08.2017	Final Design
79	15.08.2017	Final Design
80	15.08.2017	Final Design
81	15.08.2017	Final Design
82	15.08.2017	Final Design
83	15.08.2017	Final Design
84	15.08.2017	Final Design
85	15.08.2017	Final Design
86	15.08.2017	Final Design
87	15.08.2017	Final Design
88	15.08.2017	Final Design
89	15.08.2017	Final Design
90	15.08.2017	Final Design
91	15.08.2017	Final Design
92	15.08.2017	Final Design
93	15.08.2017	Final Design
94	15.08.2017	Final Design
95	15.08.2017	Final Design
96	15.08.2017	Final Design
97	15.08.2017	Final Design
98	15.08.2017	Final Design
99	15.08.2017	Final Design
100	15.08.2017	Final Design

LEGEND

- I LCC Recommendations
- H Revised Criteria
- G Revised for the Services
- F Revised for the Services
- E Revised Planning
- D Revised for the Services
- C Construction conditions
- B General Remarks
- A Proposed Installation
- Other Check Date

Key Plan:



Client:
Sell and Parker Pty Ltd

Project:
Proposed Alterations to
Existing Recycling Center
23 & 45 Tattersall Rd, Kings Park

SITE IMAGE

 10/11 St. Marks Street
 Brisbane QLD 4000
 Australia
 Tel: (61 7) 3200 2677
 Fax: (61 7) 3200 2677
 www.siteimage.com.au
 Site Image Pty Ltd
 ABN 42 712 208 111

CONSTRUCTION CERTIFICATE
 Drawing Name:
Coversheet

Scale:
Job Number:
Drawing Number:
Sheet:
SS15-3178
000 1

NOT FOR CONSTRUCTION

© 2018 Site Image (NSW) Pty Ltd. All rights reserved. This drawing is copyright and the property of Site Image (NSW) Pty Ltd. It is not to be reproduced, stored in a retrieval system, or transmitted in any form or by any means, electronic or mechanical, including photocopying, recording, or by any information storage or retrieval system, without the written permission of Site Image (NSW) Pty Ltd. This drawing is provided for your information only and is not to be used for any other purpose. The client is responsible for ensuring that the drawing is used in accordance with the terms of the agreement between Site Image (NSW) Pty Ltd and the client.

Drawn	Checked	Date
JL	NM	22.03.2017
SM	NM	23.03.2017
SM	NM	13.02.2017
SM	NM	31.01.2017
JL	NM	18.12.2016
JL	NM	18.12.2016
SM	NM	04.10.2016
SM	NM	17.09.2016
JW	NM	17.09.2016
JW	NM	17.09.2016

- J LEC Amendments
- A Approved for construction
- C Checked for compliance
- H Handed for the services
- I Updated landscaping
- E Elected landscaping
- D Construction certificate
- B General Notes
- A For Comment
- N None

LEGEND

- - - Site Boundary
- - - Existing vegetation to be retained, with additional landscape vegetation
- - - Turf
- - - Existing tree to be removed
- - - Existing tree to be retained
- - - Proposed tree planting



Client: Sell and Parker Pty Ltd

Project: Proposed Alterations to Existing Recycling Center
23 & 45 Tattersall Rd, Kings Park

SITE IMAGE



Level: 1 - 1:500 (Scale)
Level: 2 - 1:500 (Scale)
Level: 3 - 1:500 (Scale)
Level: 4 - 1:500 (Scale)
Level: 5 - 1:500 (Scale)
Level: 6 - 1:500 (Scale)
Level: 7 - 1:500 (Scale)
Level: 8 - 1:500 (Scale)
Level: 9 - 1:500 (Scale)
Level: 10 - 1:500 (Scale)
Level: 11 - 1:500 (Scale)
Level: 12 - 1:500 (Scale)
Level: 13 - 1:500 (Scale)
Level: 14 - 1:500 (Scale)
Level: 15 - 1:500 (Scale)
Level: 16 - 1:500 (Scale)
Level: 17 - 1:500 (Scale)
Level: 18 - 1:500 (Scale)
Level: 19 - 1:500 (Scale)
Level: 20 - 1:500 (Scale)
Level: 21 - 1:500 (Scale)
Level: 22 - 1:500 (Scale)
Level: 23 - 1:500 (Scale)
Level: 24 - 1:500 (Scale)
Level: 25 - 1:500 (Scale)
Level: 26 - 1:500 (Scale)
Level: 27 - 1:500 (Scale)
Level: 28 - 1:500 (Scale)
Level: 29 - 1:500 (Scale)
Level: 30 - 1:500 (Scale)
Level: 31 - 1:500 (Scale)
Level: 32 - 1:500 (Scale)
Level: 33 - 1:500 (Scale)
Level: 34 - 1:500 (Scale)
Level: 35 - 1:500 (Scale)
Level: 36 - 1:500 (Scale)
Level: 37 - 1:500 (Scale)
Level: 38 - 1:500 (Scale)
Level: 39 - 1:500 (Scale)
Level: 40 - 1:500 (Scale)
Level: 41 - 1:500 (Scale)
Level: 42 - 1:500 (Scale)
Level: 43 - 1:500 (Scale)
Level: 44 - 1:500 (Scale)
Level: 45 - 1:500 (Scale)
Level: 46 - 1:500 (Scale)
Level: 47 - 1:500 (Scale)
Level: 48 - 1:500 (Scale)
Level: 49 - 1:500 (Scale)
Level: 50 - 1:500 (Scale)

CONSTRUCTION CERTIFICATE
Landscape Masterplan

Drawing Name:

Scale: 1:500 @ A1
Job Number: SS-15-3178
Drawing Number: 101 J

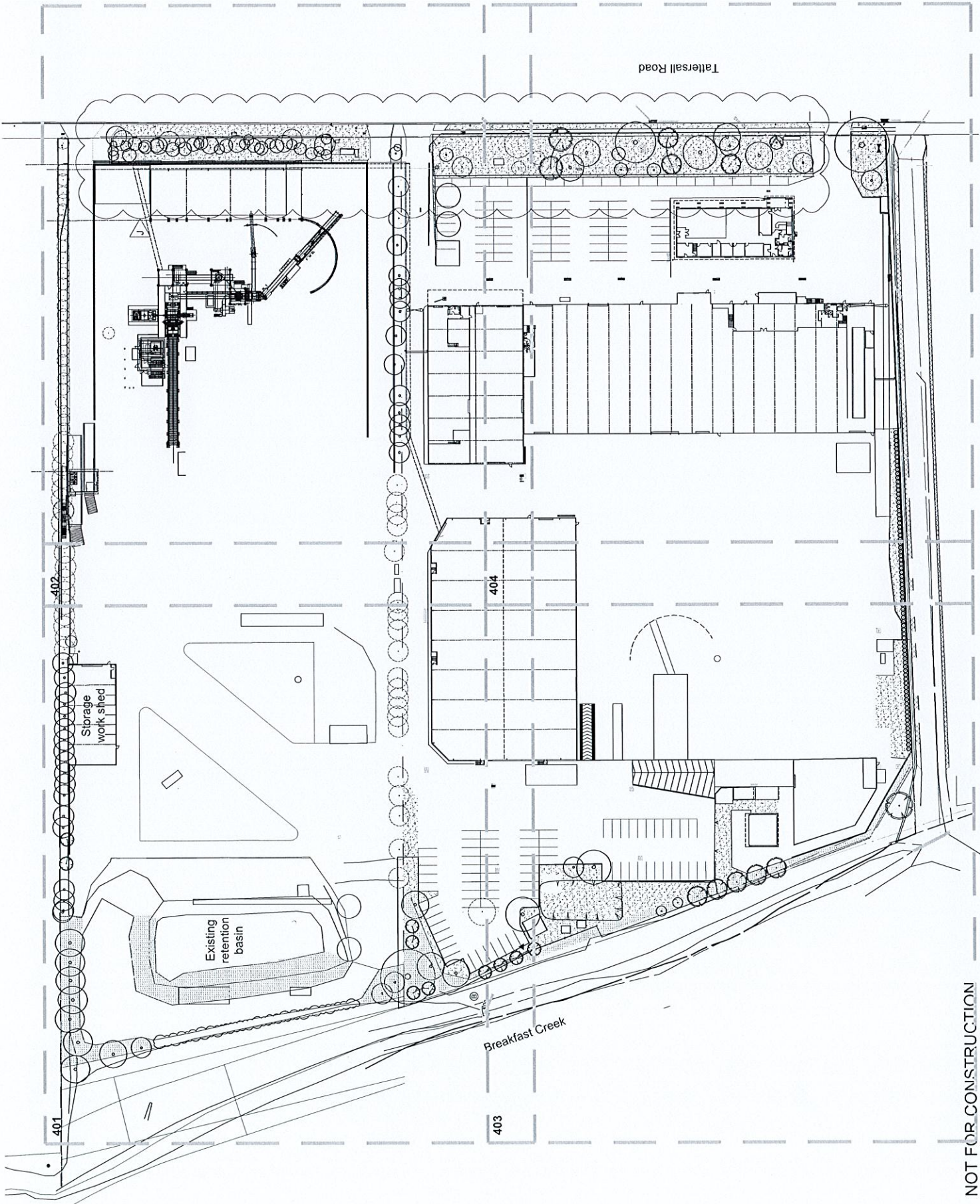

NOT FOR CONSTRUCTION

© 2016 Site Image (NSW) Pty Ltd. All rights reserved. This drawing is copyright and the property of Site Image (NSW) Pty Ltd. It is to be used only for the project and site for which it was prepared. No part of this drawing may be reproduced, stored in a retrieval system, or transmitted in any form or by any means, electronic, mechanical, photocopying, recording, or otherwise, without the written permission of Site Image (NSW) Pty Ltd. The user of this drawing shall be deemed to have agreed to the terms and conditions of the license agreement between Site Image (NSW) Pty Ltd and the user.

The architect shall check and certify all work on site. Retaining work by others shall be undertaken at the discretion of the architect. Any alterations to the original design shall be undertaken by the architect. Any proposed construction not shown shall be referred to the Landscape Architect for confirmation.

JD	NSW	22.08.2017
JD	NSW	19.08.2018
JD	NSW	19.03.2018
SM	NSW	04.10.2018
SM	NSW	04.10.2018
JW	NSW	17.03.2018
JW	NSW	17.03.2018
JW	NSW	13.02.2018
		Drawn
		Checked
		Date

- G LEC Alterations
- H Proposed hardscaping
- E Existing hardscaping
- D Construction certificate
- C Construction certificate
- S General Reservations
- A For Comment

LEGEND

- Site boundary
- Existing vegetation to be retained
- Existing vegetation to be removed
- Turf
- Existing trees to be retained
- Existing trees to be removed
- Proposed tree planting

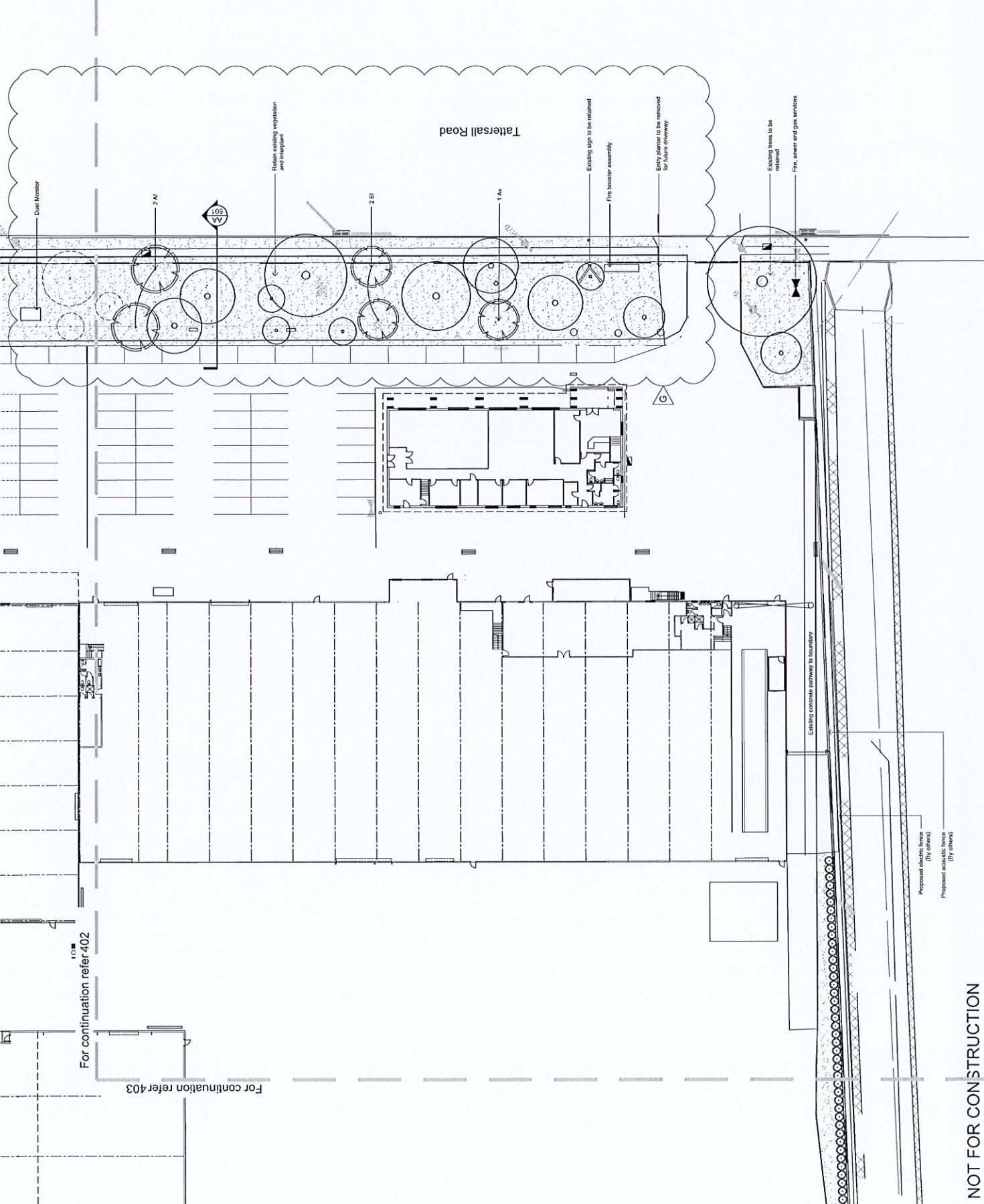

Client: Sell and Parker Pty Ltd

Project: Proposed Alterations to Existing Recycling Center 23 & 45 Tattersall Rd, Kings Park

SITE IMAGE

Level 1, 3rd Street Street
 Australia
 Tel: 61 2 8322 5600
 Fax: 61 2 8322 5601
 www.siteimage.com.au
 Site Image (NSW) Pty Ltd
 A/CN 61 762 380

Landscape Architects

CONSTRUCTION CERTIFICATE
 Landscape Plan

Scale: 1:250 @ A1
 Job Number: SS15-3178
 Drawing Number: 404 G

NOT FOR CONSTRUCTION

